

3D OVERALL

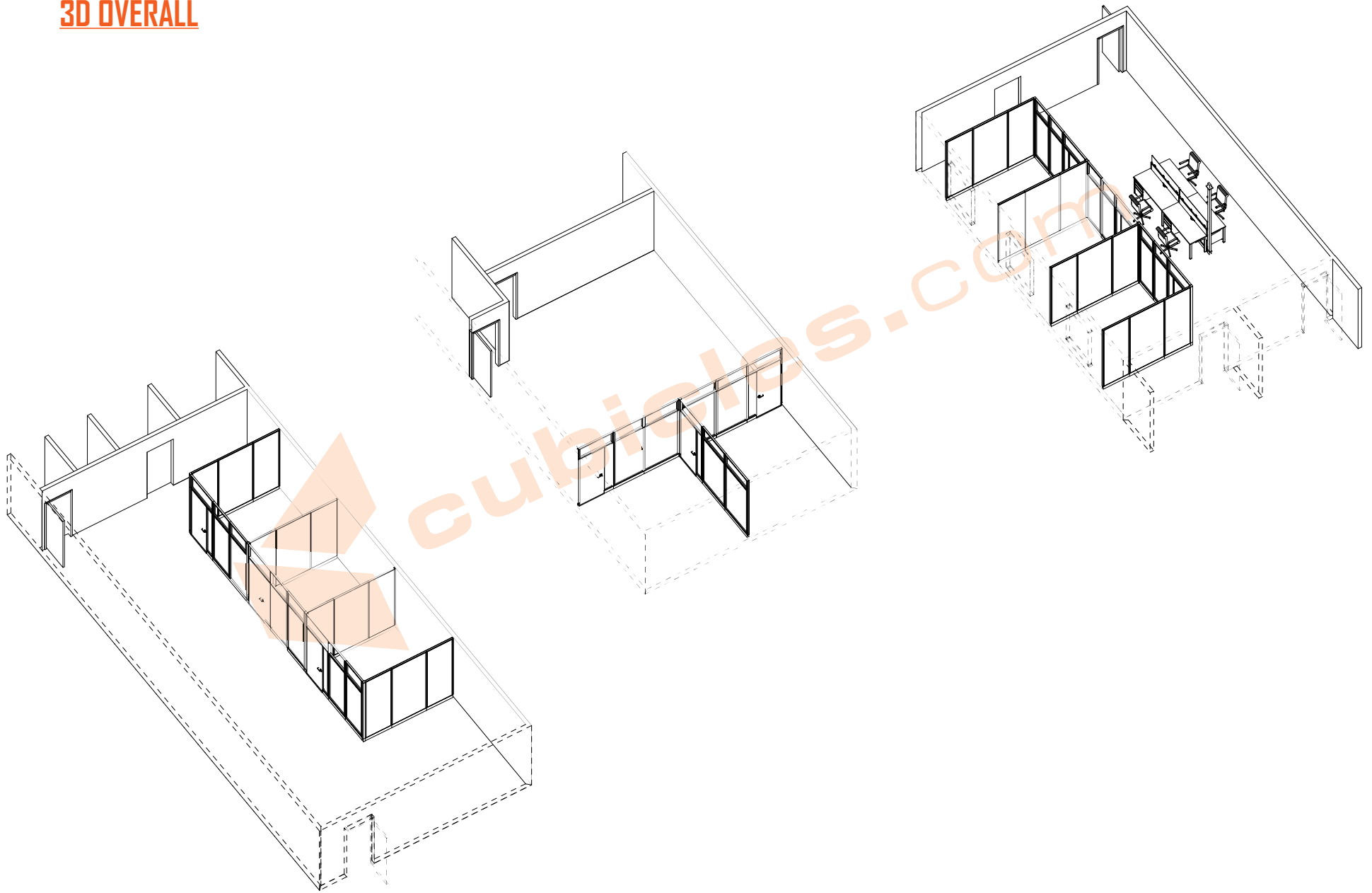

SUITE A - 1ST FLOOR

2D & 3D LAYOUTS

SCOPE

O2 MODULAR OFFICE SYSTEM | O2 I-BENCH STATIONS

THIN BASE | GRADE 2 FINISHES

[3] 10' X 9' X 107"H NON-POWERED

MODULAR WALL OFFICES W/ HINGED DOOR

* 4'H FROSTED FILM STRIP APPLIED ON GLAZED PANELS

[4] 2' X 5' X 39"H + 13"H SCREENS POWERED STATIONS W/

[1] MOBILE BOX-BOX-FILE PEDESTAL W/CUSHION /EA



REFERENCE IMAGES - NOT SPECIFIC TO THIS PROJECT

* SEATING NOT INCLUDED - AVAILABLE UPON REQUEST

NEW FURNITURE
POWERED ELEMENTS
NOTES

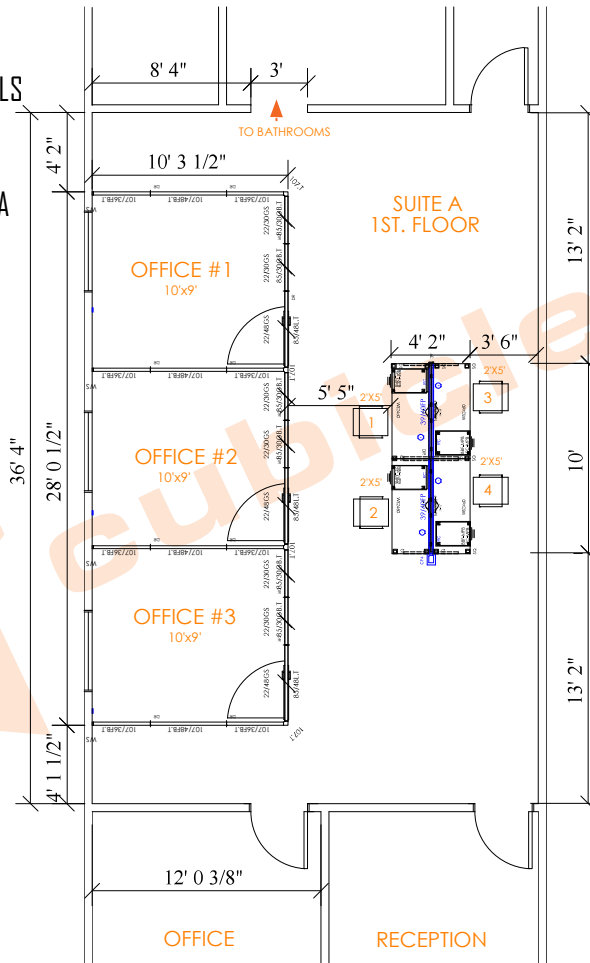

2D LAYOUT

3D OVERVIEW

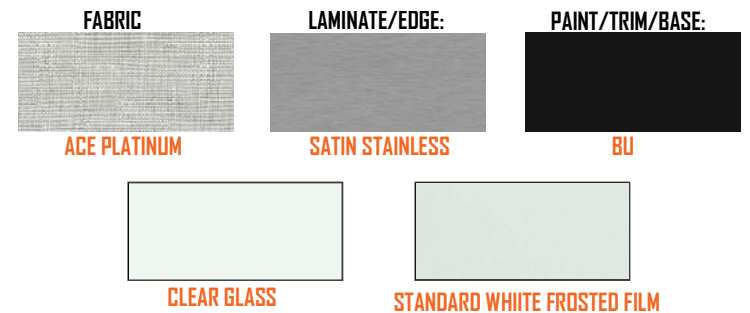
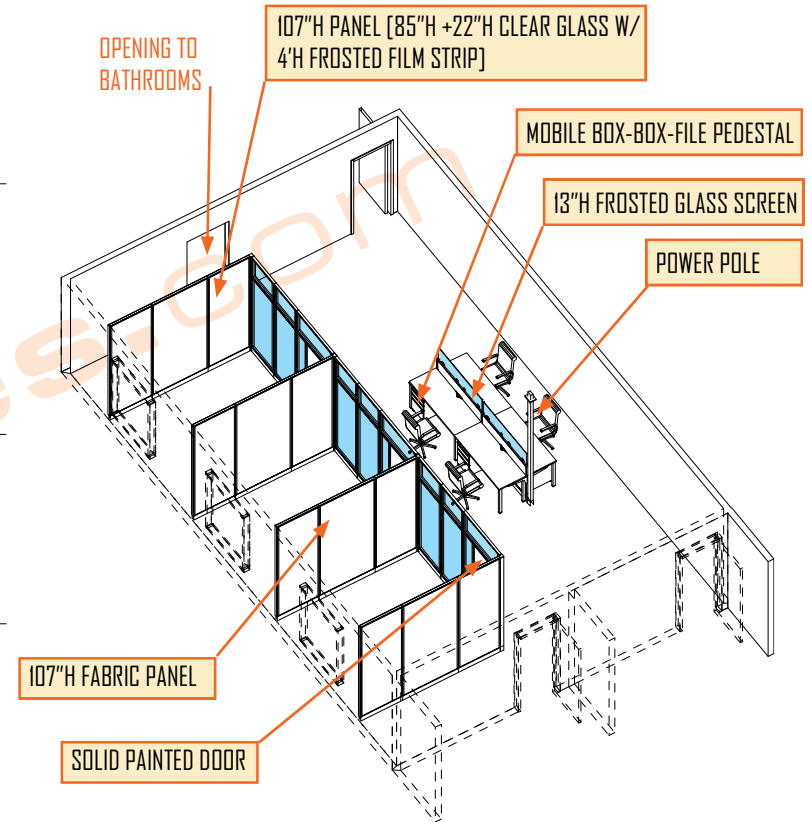

SUITE B- 1ST FLOOR 2D & 3D LAYOUTS

SCOPE
02 MODULAR OFFICE SYSTEM
THIN BASE | GRADE 2 FINISHES

[3] 10' X 10' X 107"H NON-POWERED
MODULAR WALL OFFICES W/ HINGED DOOR
* 4'H FROSTED FILM STRIP APPLIED ON GLAZED
PANELS

2D LAYOUT

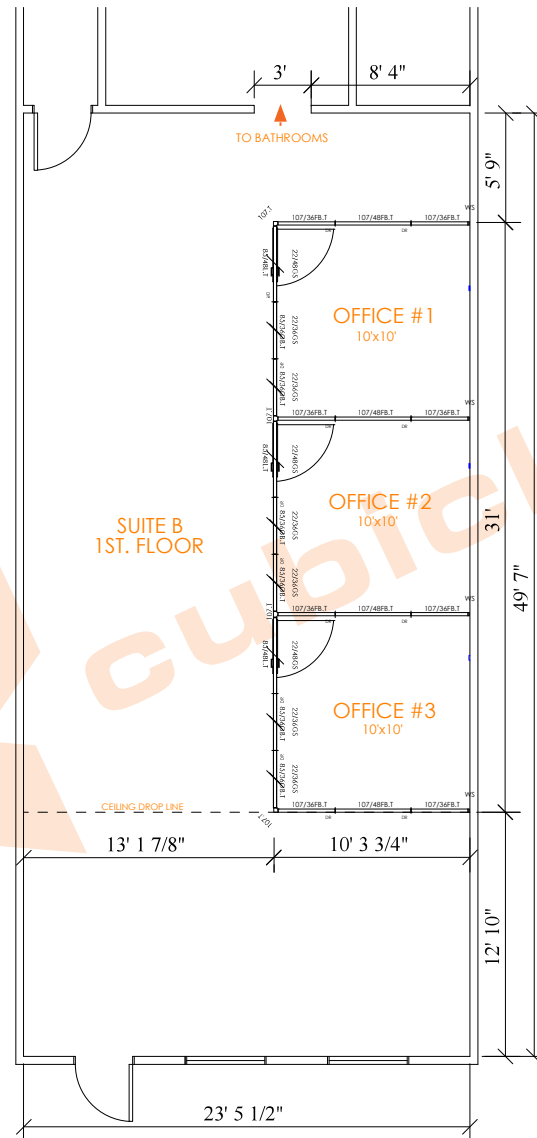

NEW FURNITURE
NOTES

3D OVERVIEW

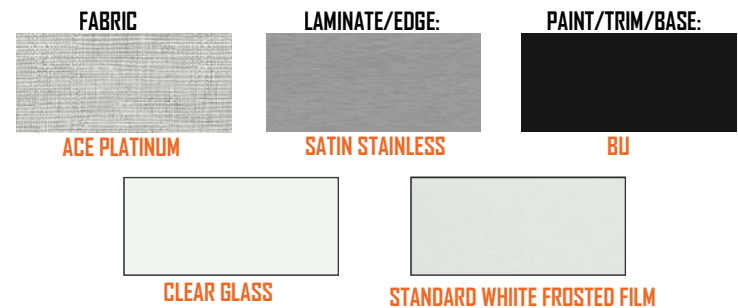
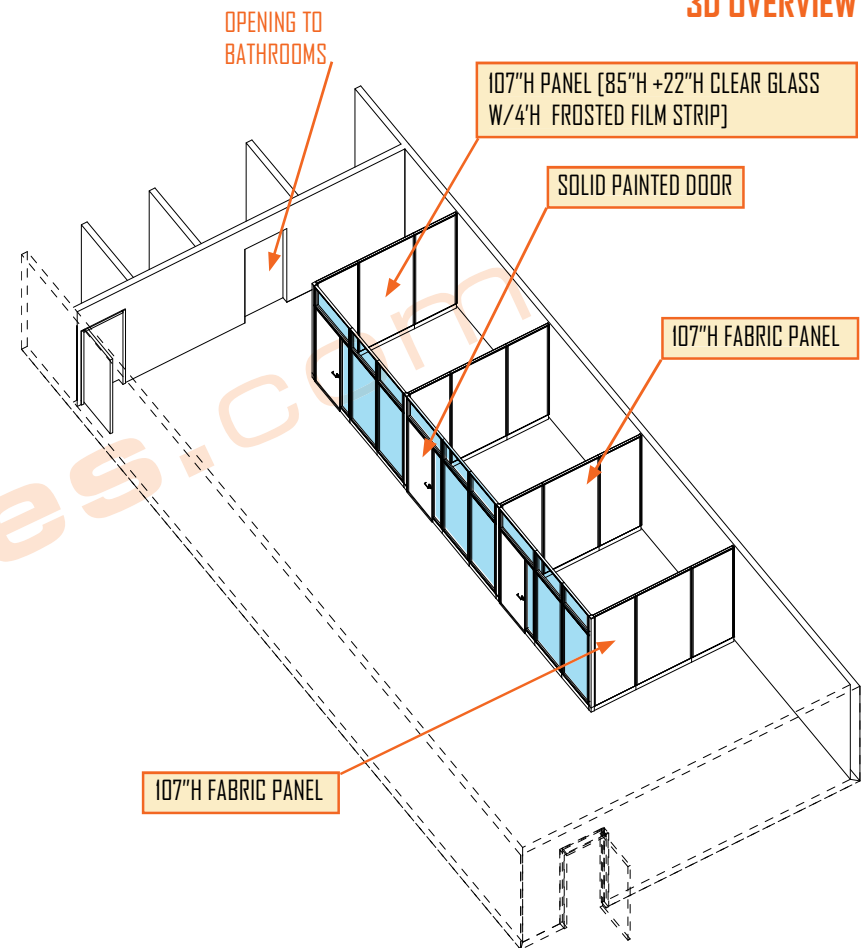

REFERENCE IMAGES - NOT SPECIFIC TO THIS PROJECT

SUITE B- 2ND FLOOR 2D & 3D LAYOUTS

SCOPE
02 MODULAR OFFICE SYSTEM
THIN BASE | GRADE 2 FINISHES

[2] 12' X 11'-8" X 103"H NON-POWERED
MODULAR WALL OFFICES W/ [3] HINGED DOORS
* 4'H FROSTED FILM APPLIED ON FRONT PANELS ONLY



REFERENCE IMAGES - NOT SPECIFIC TO THIS PROJECT

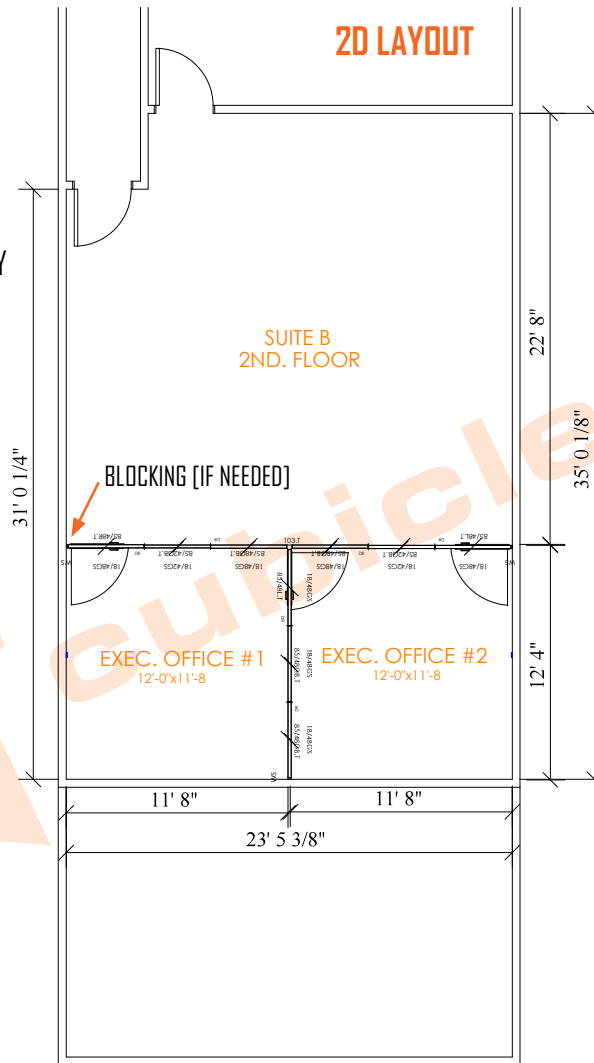

NEW FURNITURE
 NOTES

103"H PANEL [85"H + 18"H CLEAR GLASS W/ 4'H
FROSTED FILM STRIP ON FRONT PANELS ONLY]

3D OVERVIEW

HINGED DOOR W/
GLASS INSERT

HINGED DOOR W/
GLASS INSERT

103"H PANEL [85"H + 18"H
CLEAR GLASS]

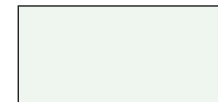

CLEAR GLASS



STANDARD WHITE FROSTED FILM

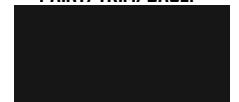

BU

PAINT/TRIM/BASE: